

---

*Comfort-Aire*®

**Century**®

---

REPLACEMENT PARTS LIST

**Hyper Heat Single Zone Air Handler &  
Condenser**

A-VXP36SA-1

# EXPLODED VIEW

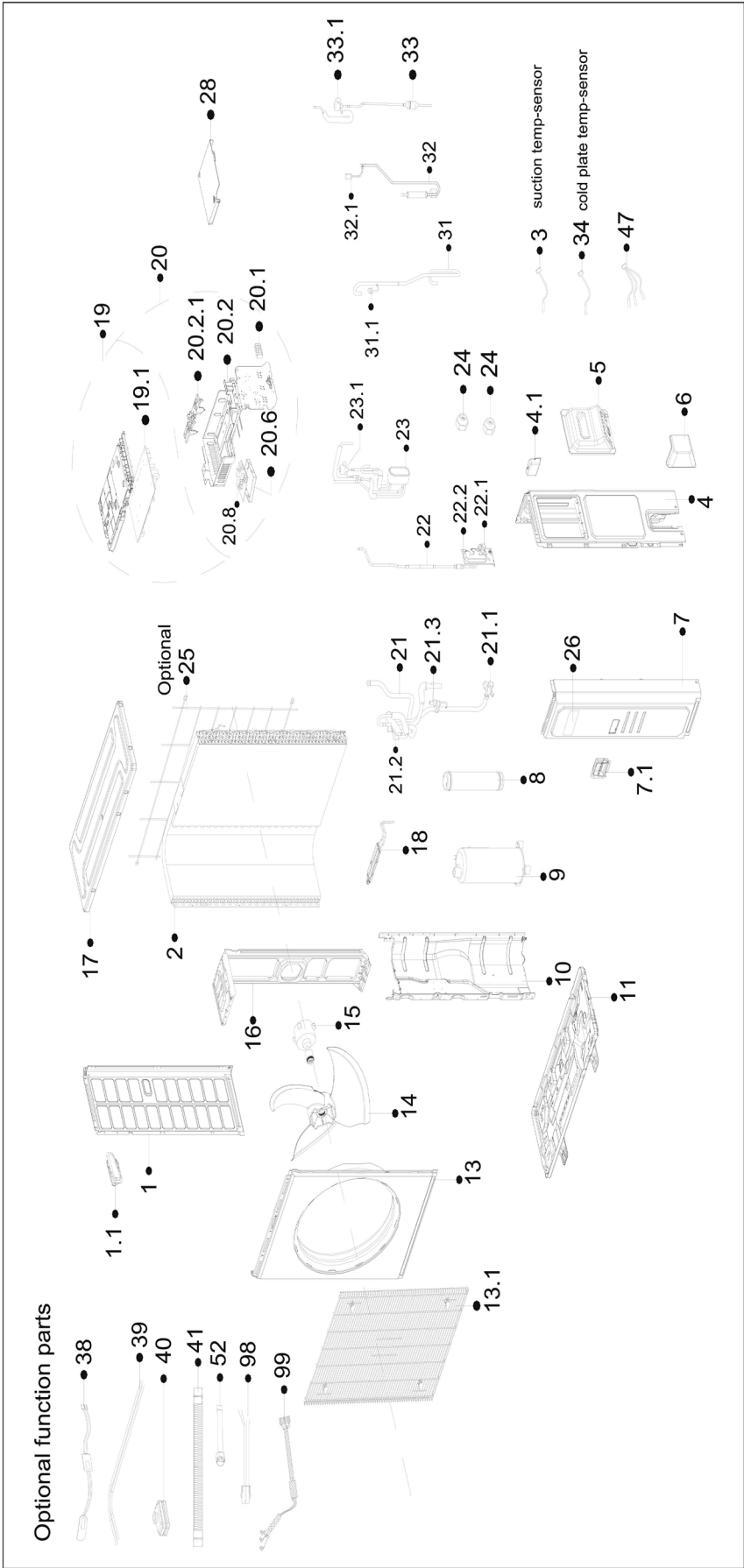

# REPLACEMENT PARTS

Location	Part Name	Quantity	Part No.
1	Left supporter	1.0	12222000018386
1.1	Small handle	1.0	12100701000033
2	Condenser assembly	1.0	15823000007703
3	Pipe temperature sensor subassembly	1.0	11201007000124
4	rear right side plate assembly	1.0	12222500002932
4.1	Handle	1.0	12100702000170
5	Cover plate subassembly	1.0	12222000018396
6	Water collector	1.0	12122200002695
7	front right side plate assembly	1.0	12222000018406
7.1	Handle	1.0	12100702000170
8	Accumulator cylinder	1.0	15500508001515
9	compressor	1.0	11103020015083
10	Partition board subassembly	1.0	12222200008215
11	Chassis assembly	1.0	12222000018397
13	Front panel	1.0	12222000018392
13.1	Air outlet grille	1.0	12222000018393
14	axial flow fan	1.0	12100105001401
15	Motor	1.0	11002015018478
16	Motor bracket assembly	1.0	12222000018307
17	Top cover assembly	1.0	12222000018385
18	Radiator	1.0	15122000034108
19	Electronic control box subassembly	1.0	17222000043459
19.1	Outdoor main control board subassembly	1.0	17122000063044
20	Electronic control box terminal board assembly	1.0	17222300004750
20.1	Terminal block	1.0	17400401006516
20.2	Electronic installing box subassembly	1.0	12222000019085
20.2.1	Holder for U-Typed Copper Pipe	1.0	12122000033782
20.6	Electronic installing box	1.0	12122000035062
20.8	Data Conversion Module Subassembly	1.0	17122000063045
21	4-way valve assembly	1.0	15422000026837
21.1	Gas valve	1.0	15500204000662
21.2	4-way valve	1.0	15500216002483
21.3	pressure sensor	1.0	11201008001132
22	High pressure valve assembly	1.0	15422000026835
22.1	High pressure valve	1.0	15500204000665
22.2	Valve plate	1.0	12222200000611
23	Heat exchanger subassembly	1.0	15700101001856
23.1	Electronic expansion valve subassembly	1.0	15422000025600
24	Copper nut	1.0	15500406000010
24	Copper nut	1.0	15500406000008
25	Rear Grille	1.0	12222000017766
26	Outdoor unit trademark	1.0	16000201001228
28	Cover of electronic control box	1.0	12222000018405
31	Suction pipe subassembly	1.0	15122000033008
31.1	Pressure switch	1.0	17400516000848
32	Discharge pipe subassembly	1.0	15122000033006
32.1	Pressure switch	1.0	17400516000849
33	Electronic expansion valve subassembly	1.0	15422000025555
33.1	Electronic expansion valve	1.0	11501020000201
34	Pipe temperature sensor subassembly	1.0	11201007003447
38	Crankcase electric heater	1.0	17402001001059
39	Electric heater of chassis	1.0	17402002000466
47	combination sensor	1.0	11201011001107
52	evaporator connecting pipe subassembly	1.0	15123000012948
52	evaporator connecting pipe subassembly	1.0	15123000012887

---

Due to ongoing product improvements, specifications and dimensions are subject to change and correction without notice or incurring obligations. Determining the application and suitability for use of any product is the responsibility of the installer. Additionally, the installer is responsible for verifying dimensional data on the actual product prior to beginning any installation preparations.

Incentive and rebate programs have precise requirements as to product performance and certification. All products meet applicable regulations in effect on date of manufacture; however, certifications are not necessarily granted for the life of a product. Therefore, it is the responsibility of the applicant to determine whether a specific model qualifies for these incentive/rebate programs.

*Comfort-Cire*®  **Century**®

1900 Wellworth Avenue • Jackson, MI 49203 • 517-787-2100